

DIGITAL INVENTORY AND LEAK DETECTION PROBES

Digital inventory and leak detection probes provide accurate tank level monitoring and reporting with optional leak detection capabilities. These probes employ digital magnetostrictive position measurement technology for highly accurate tank readings.

HIGHLIGHTS

- Models available for inventory control or inventory control with leak detection.
- Capable of precise leak detection, density measurement, and inventory monitoring.
- Suitable for use with gasoline, diesel, DEF/AdBlue®, and other manufacturer approved products.
- Bottom mounted installation for fast and simple install.
- Vibration motor integrated into probe head pulses every 5 minutes to reduce the effects of stiction on level reading and leak detection, providing readings with higher accuracy.
- Screw-in electrical connector provides quick installation or removal, eliminating the need to re-splice wires.
- Highly accurate digital communication between the probe and the tank gauge.
- Probes are available in many sizes that are suitable for all common tanks.
- Easily installed into 2", 3" or 4" riser pipes.

SPECIFICATIONS

- Operating temperature: -40° to 140 °F (-40° to 60 °C)
- Storage temperature: -40° to 158 °F (-40° to 70 °C)
- Non-linearity: $\pm 0.025\%$ of full scale
- Repeatability: $\pm 0.001"$
- Temperature sensors: 5 thermistors located in the shaft
- Temperature resolution: ± 0.02 °F (± 0.01 °C)
- Probe pigtail: 10' long three conductor cables with shields and polyurethane jacket
- Compatible with up to three floats for product, water, phase separation detection, or density measurement.
- Compatible with Franklin Fueling Systems tank gauges including: EVO™ 200, EVO™ 400, EVO™ 550, EVO™ 5000.

Approvals/Certifications

- UL and cUL listed, ATEX, IECEx

Applications

Digital probes feature exceptional linearity, resolution, and stability, and are used in underground and aboveground storage tanks. Two types of probes are available for the following applications:

- The leak detection probes are typically used for underground storage tanks and petroleum applications when static or SCALD leak detection is required.
- The inventory control probes are typically used for aboveground storage tanks, chemical or oil waste, or underground storage tanks that do not require in-tank leak detection.



Inventory and Leak Detection Probe
(Shown with optional precision density diesel float kit)

Inventory Probe
(Shown with optional 4" gas float kit)

SPECIFICATIONS CONTINUED

Components

- 1 Probe head
- 2 Guides
- 3 Bottom mount fitting
- 4 Probe shaft
- 5 Product float
- 6 2" or 4" gas, diesel or phase separation water floats
- 7 Precision or standard density float
- 8 LPG float
- 9 Chemical float

Note: All float kits sold separately.

Operation

An electromagnetic field is created inside the probe head and forms around a long waveguide within the probe shaft when position measurements are taken. The electromagnetic field interacts with the magnetic field of the float(s) and produces a shock wave in the waveguide that travels at a known speed. When the shock wave is detected at the probe head, the probe creates a signal that corresponds precisely to the product level. Product expansion calculations are enabled by temperature sensors that are located at various points in the probe shaft.

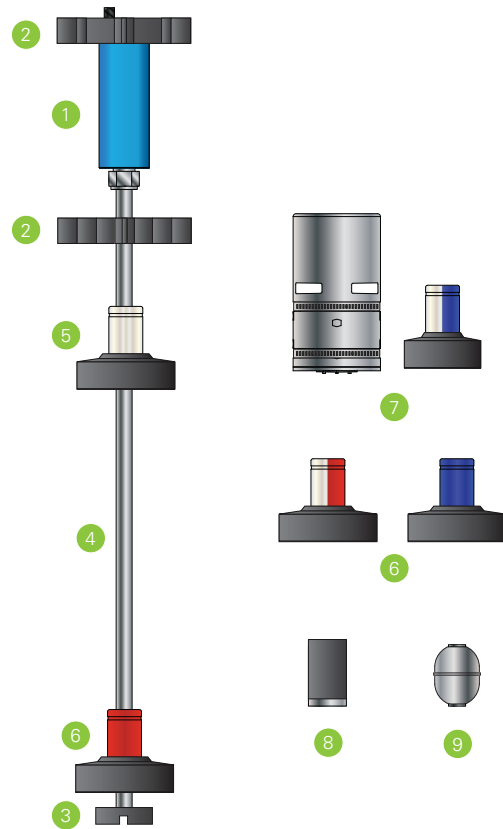

ORDERING INFORMATION

Leak Detection Probes

Model	Description
FMP-LL3-29	2' digital leak detection probe
FMP-LL3-41	3' digital leak detection probe
FMP-LL3-53	4' digital leak detection probe
FMP-LL3-65	5' digital leak detection probe
FMP-LL3-69	5'4" digital leak detection probe
FMP-LL3-77	6' digital leak detection probe
FMP-LL3-81	6'4" digital leak detection probe
FMP-LL3-89	7' digital leak detection probe
FMP-LL3-101	8' digital leak detection probe
FMP-LL3-113	9' digital leak detection probe
FMP-LL3-125	10' digital leak detection probe
FMP-LL3-131	10'6" digital leak detection probe
FMP-LL3-137	11' digital leak detection probe
FMP-LL3-149	12' digital leak detection probe

Notes:

1. DEF, AdBlue, and chemical installations require that head of the probe be installed outside of the tank and riser. Order a probe length that is greater than the tank height/diameter plus the riser.
2. FMP-LL3 probes are available in standard lengths up to 149 inches only.
3. Longer probes are available in TSP-LL2 models, contact Customer Service for price and availability.
4. Custom probe lengths are available, contact Customer Service for price and availability.
5. Float kits must be ordered separately.
6. FMP-LL3 probes come with bottom mount hardware. For replacement hardware kits, order TSSP-BMKT.

Inventory Control Probes

Model	Description
FMP-LL3-29-I	2' digital inventory control probe
FMP-LL3-41-I	3' digital inventory control probe
FMP-LL3-53-I	4' digital inventory control probe
FMP-LL3-65-I	5' digital inventory control probe
FMP-LL3-69-I	5'4" digital inventory control probe
FMP-LL3-77-I	6' digital inventory control probe
FMP-LL3-81-I	6'4" digital inventory control probe
FMP-LL3-89-I	7' digital inventory control probe
FMP-LL3-101-I	8' digital inventory control probe
FMP-LL3-113-I	9' digital inventory control probe
FMP-LL3-125-I	10' digital inventory control probe
FMP-LL3-131-I	10'6" digital inventory control probe
FMP-LL3-137-I	11' digital inventory control probe
FMP-LL3-149-I	12' digital inventory control probe